

Fuller[®]
BRUSH CO.

Home
Maid[™]

OWNER'S MANUAL
FOR FULLER BRUSH
CANISTER VACUUMS

Models
FB-HM
FB-HMP



Thank you for purchasing this
Fuller Brush Canister Vacuum.
To ensure the best results, please read this
manual first and keep it for future reference.

Index

Important Safety Instructions	2
Two-Wire Polarized Cord	3
State of California Proposition 65 Warnings	3
Parts Identification and Replacement Bags, Belts, Filters (Model FB-HMP)	4
Parts Identification and Replacement Bags, Filters (Model FB-HM)	5
How to Assemble and Operate the Vacuum	6
How to Replace the Bag	7
How to Replace the Filters	7
Tools Cleaning	8
Wand Storage	9
How to Operate the Power Nozzle	10
How to Replace the Power Nozzle Belt	11
Troubleshooting Guide	12
For Best Performance	12

Customer's Record

The model and serial number of this product may be found on the back of the unit. Register your Fuller Brush vacuum online at www.FullerBrushVacuums.com as soon as possible for your protection. Also, note the model and serial numbers of your unit in the spaces provided below, and retain this book as a permanent record of your purchase.

Model Number _____
Serial Number _____
Date Purchased _____

Your Fuller Brush vacuum cleaner is a product of high-quality materials and superior workmanship. We urge you to read these operating instructions carefully before you use this vacuum cleaner in order to obtain the full performance and satisfaction it can offer you.

Save These Instructions

Before you plug in your Fuller Brush vacuum cleaner, make sure the voltage indicated on the rating plate located on the back of the vacuum cleaner is the same as your local supply.

IMPORTANT SAFETY INSTRUCTIONS

READ ALL INSTRUCTIONS BEFORE USING THIS APPLIANCE.

When using an electrical appliance, basic precautions should always be followed, including the following:

SAVE THESE INSTRUCTIONS.

WARNING: To reduce the risk of fire, electric shock or injury:

1. Do not leave appliance unattended when plugged in. Unplug from outlet when not in use and before servicing.
2. **WARNING: ELECTRIC SHOCK COULD OCCUR IF USED OUTDOORS OR ON WET SURFACES.**
3. Do not allow to be used as a toy. Close attention is necessary when used by or near children.
4. Use only as described in this manual. Use only manufacturer's recommended attachments.
5. Do not use with damaged cord or plug. If appliance is not working as it should, has been dropped, damaged, left outdoors or dropped into water, return it to a service center.
6. Do not pull or carry by cord, use cord as a handle, close a door on cord, or pull cord around sharp edges or corners. Do not run appliance over cord. Keep cord away from heated surfaces.
7. Do not unplug by pulling on cord. To unplug, grasp the plug, not the cord.
8. Do not handle plug or appliance with wet hands.
9. Turn off all controls before unplugging.
10. Do not put any object into openings. Do not use with any opening blocked; keep free of dust, lint, hair and anything that may reduce air flow.
11. Keep hair, loose clothing, fingers and all parts of the body away from openings and moving parts.
12. Do not pick up anything that is burning or smoking, such as cigarettes, matches or hot ashes.
13. Do not use without vacuum filters in place.
14. Use extra care when cleaning on stairs.
15. Do not use to pick up flammable or combustible liquids such as gasoline or use in areas where they may be present.
16. Do not attempt to service the unit while appliance is plugged in.

Two-Wire Polarized Cord

This product is equipped with a polarized alternating current line plug (a plug having one blade wider than the other). This plug fits into the power outlet only one way. This is a safety feature. If you are unable to insert the plug fully into the outlet, try reversing the plug. If the plug should still fail to fit, contact an electrician to replace the obsolete outlet. Do not defeat the safety purpose of the polarized plug.

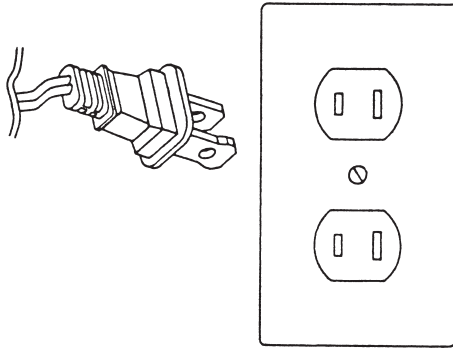

State of California Proposition 65 Warnings:

WARNING: This product contains one or more chemicals known to the State of California to cause cancer.

WARNING: This product contains one or more chemicals known to the State of California to cause birth defects or other reproductive harm.

Parts Identification

MODEL FB-HMP

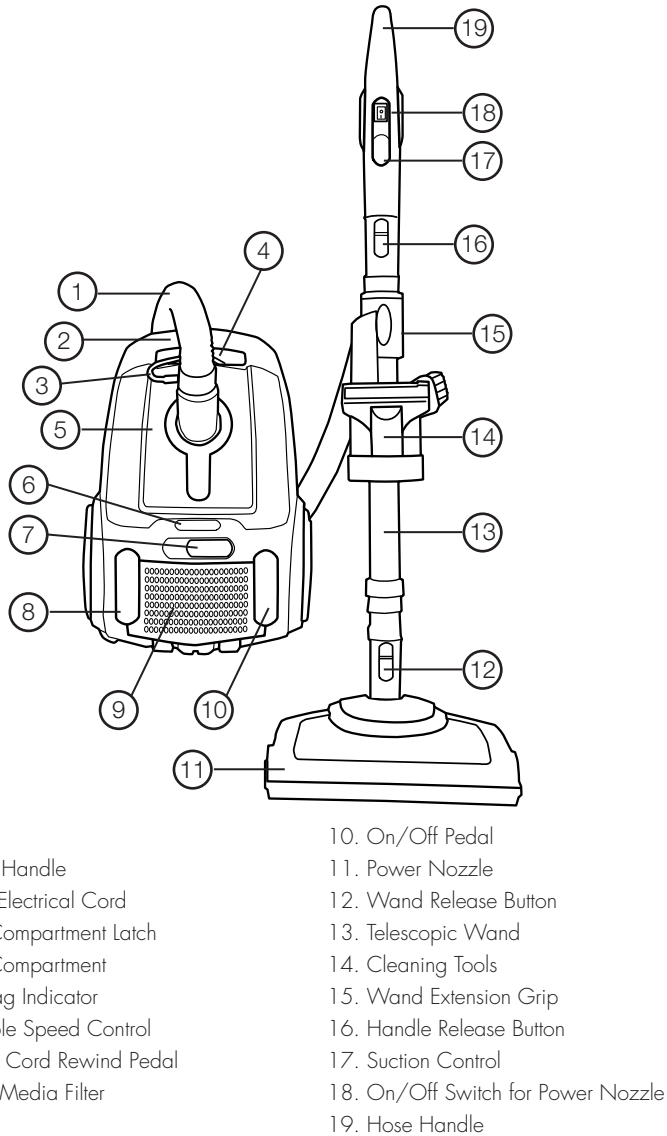

Replacement Bags, Belts and Filters

- Genuine Fuller Brush Vacuum Bags
Package of 6 Part # FHH-6
- Genuine Fuller Brush Filter Set
Part # FBHM-HEPA
- Genuine Fuller Brush Power Nozzle Belt
Package of 2 Part # FBHMP-B2

Parts Identification

MODEL FB-HM

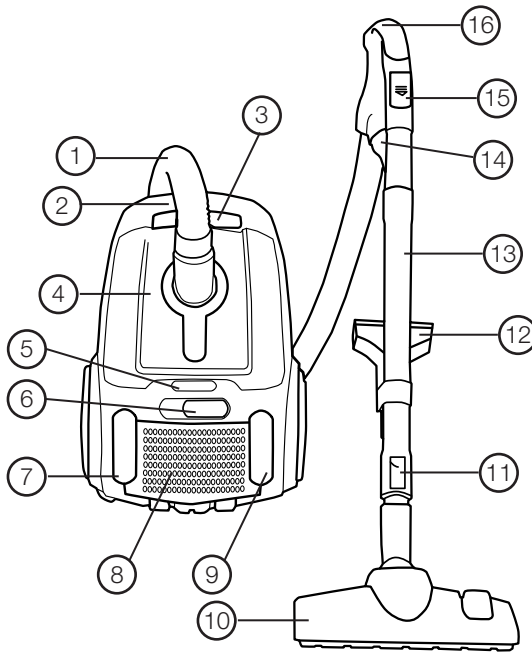

1. Hose
2. Carry Handle
3. Bag Compartment Latch
4. Bag Compartment
5. Full Bag Indicator
6. Variable Speed Control
7. Power Cord Rewind Pedal
8. HEPA Media Filter

9. On/Off Pedal
10. Rug/Floor Tool
11. Wand Extension Button
12. Upholstery Tool
13. Telescopic Wand
14. Cleaning Tools
15. Suction Control
16. Hose Handle

Replacement Bags and Filters

- Genuine Fuller Brush Vacuum Bags.
Package of 6. Part # FHH-6

- Genuine Fuller Brush Filter Set
Part # FBHM-HEPA

How to Assemble and Operate the Vacuum

How to Assemble and Operate the Vacuum

The vacuum, hose, wand and accessories are packed separately.

1. Push the hose cuff into the hose inlet on the top of the bag compartment until it clicks into place (Fig. 1).
2. Attach the electrical cord from the hose into the plug underneath the carry handle (FB-HMP model only) (Fig. 2).

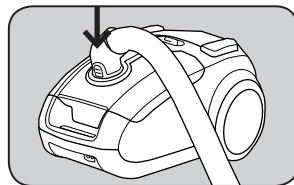

Fig. 1

How to Extend the Wand

Grasp the wand extension grip (FB-HMP model) or the wand extension button (FB-HM model) and pull up on the hose handle to extend the wand to the desired length.

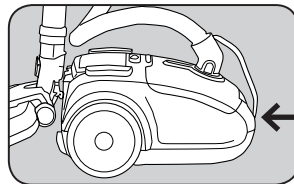

Fig. 2

On/Off Switch

1. To turn the vacuum on, push the power pedal on the top of the vacuum.
2. To turn the vacuum off, push the pedal again.
3. To turn the power nozzle on, turn the vacuum on first, then push the On/Off switch on the hose handle to the "On" position (FB-HMP model only).

Full Bag Indicator

1. If the full bag indicator appears, change the vacuum bag.
2. If the full bag indicator appears, but the vacuum bag is not full, check the hose for a clog.

NOTE: When cleaning with a tool (dusting brush, upholstery tool or crevice tool), the full bag indicator may appear. In this case, continue cleaning, as the indicator will likely go off once the tools are no longer in use.

Variable Speed Control

To adjust the motor power, slide the variable speed control on the canister body to the desired motor speed.

Suction Control

To adjust the suction level, slide the suction control switch on the handle to reach the desired level of suction.

How to Replace the Vacuum Bag

Always operate the vacuum cleaner with a bag installed properly. Change the vacuum bag when the full bag indicator appears or when suction power is weak. The bag compartment lid will not close without a bag in the holder or if the bag is not properly installed.

1. Disconnect the hose from the canister by squeezing the two tabs on the hose cuff and pulling it out of the inlet (Fig 1).
2. Disconnect the electrical cord on the hose cuff from beneath the carrying handle (FB-HMP model only).
3. Open the bag compartment lid.
4. Remove the bag holder by pulling it up and out of the bag compartment (Fig 2).
5. Remove the bag by sliding the cardboard collar out of the bag holder (Fig 3).
6. Slide a new bag into the bag holder until it clicks into place.
7. Insert the bag holder back into the bag compartment.
8. Replace the hose. Reconnect the electrical cord (FB-HMP model only).

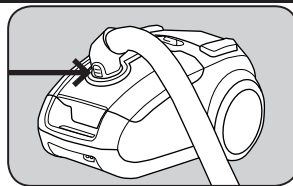

Fig. 1

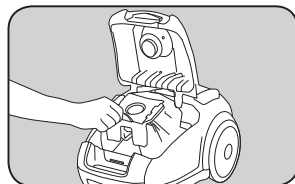

Fig. 2

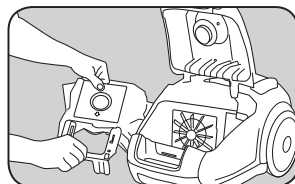

Fig. 3

How to Replace the Vacuum Filters

When to Change the Filters

At a minimum, it's recommended to replace the HEPA media and secondary filters after using 12 vacuum bags. If someone in your household is sensitive to airborne allergens, it is recommended to change the filters after every six vacuum bags.

How to Replace the HEPA Media Filter

1. Lift up the two tabs of the filter cover to access the HEPA media filter (Fig 1).
2. Remove the used filter and discard.
3. Insert a new filter and snap the filter cover back into place (Fig 2).

NOTE: The HEPA media filter cannot be washed and reused.

How to Replace the Secondary Filter

1. Disconnect the hose from the canister by pushing in on the two tabs on the hose cuff and pulling it out of the inlet.
2. Disconnect the electrical cord on the hose cuff from beneath the carrying handle (FB-HMP model only).
3. Open the bag compartment lid.
4. Remove the bag holder by pulling it up and out of the bag compartment.
5. Locate the filter behind the vacuum bag.
6. Pull the filter holder up and out of the bag compartment (Fig 3).
7. Remove the used filter and discard.
8. Insert a new filter into the holder and slide the holder back into place.

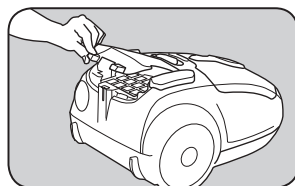

Fig. 1

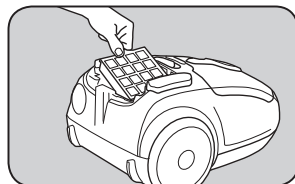

Fig. 2

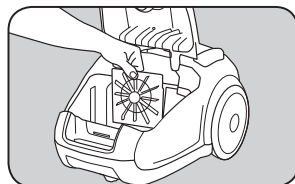

Fig. 3

Tools Cleaning

The Home Maid canister is equipped with a metal telescopic wand, hose, crevice tool, dusting brush, upholstery tool and rug/floor tool. All of these tools can be attached to the end of the wand or to the hose handle for convenient cleaning.

Crevice Tool

The crevice tool is ideal for hard to reach places and along baseboards (Fig. 1).

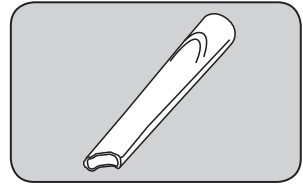

Fig. 1

Dusting Brush

The dusting brush is ideal for vacuuming delicate objects and surfaces (Fig. 2).

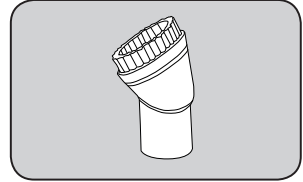

Fig. 2

Upholstery Tool

The upholstery tool cleans pet hair quickly and easily from sofas and chairs (Fig. 3).

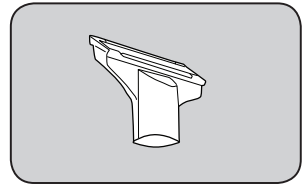

Fig. 3

Rug/Floor Tool

This tool is great for cleaning area rugs with the brushes retracted and glides along tile, hardwood and vinyl floors with the brushes exposed. When attached to the wand, this tool conveniently stores on the back of the vacuum (Fig. 4).

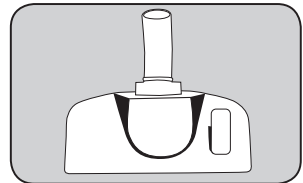

Fig. 4

Tools Storage

FB-HMP Model

The crevice tool, dusting brush and upholstery tool are conveniently stored on the removable tool caddy attached to the wand (Fig. 5).

FB-HM Model

The crevice tool and dusting brush are conveniently stored on the hose handle for easy reach. The upholstery tool is stored on the tool caddy attached to the wand (Fig. 6).

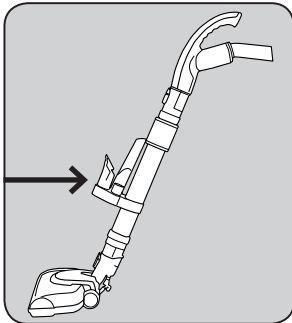

Fig. 5

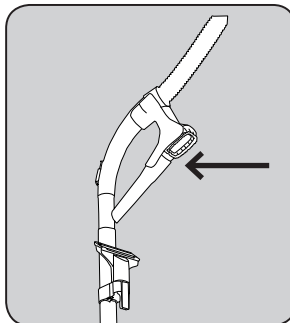

Fig. 6

Wand Storage

How to Store the Wand

FB-HMP Model

1. The tab on the back of the wand conveniently stores onto the back of the vacuum (Fig. 1).
2. The tab on the back of the tool caddy conveniently stores on the bottom of the vacuum (Fig. 3).

FB-HM Model

1. The tab on the back of the rug/floor tool conveniently stores on the back of the vacuum when it is attached to the end of the wand (Fig. 2).
2. The tab on the back of the tool caddy conveniently stores on the bottom of the vacuum (Fig. 3).

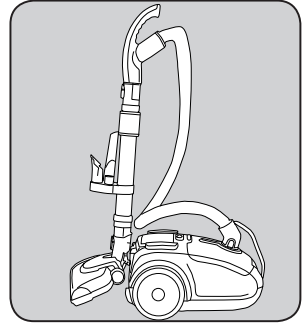

Fig. 1

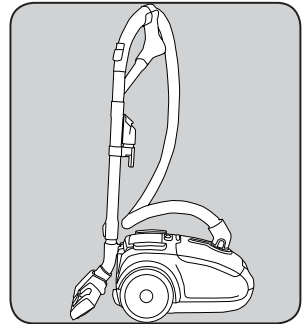

Fig. 2

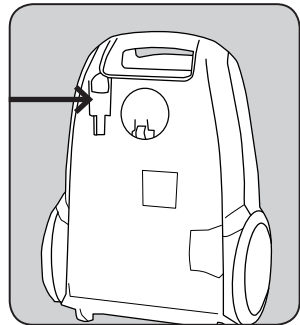

Fig. 3

How to Operate the Power Nozzle

FB-HMP Model

How to Turn On the Power Nozzle

1. The power nozzle can only be turned on if the canister is also turned on. The canister On/Off pedal is located on the main body.
2. The power nozzle On/Off switch is located on the handle. Simply press the switch forward to engage the power nozzle (Fig. 1).

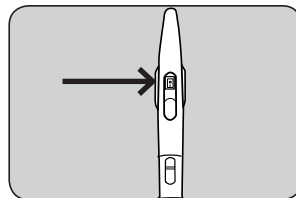

Fig. 1

How to Use the Power Nozzle

1. Turn on the canister and lower the wand by stepping on the top of the power nozzle and pulling the wand toward you (Fig. 2).
2. Turn on the power nozzle.

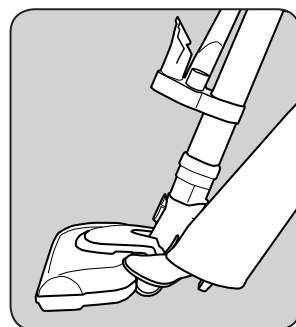

Fig. 2

How to Remove and Insert the Wand

1. Removing the wand from the power nozzle allows you to use cleaning tools for baseboard or ceiling cleaning. Turn the power nozzle and canister off. Then press the wand release button and pull the wand out (Fig. 3).
2. To reinsert the wand into the power nozzle, simply press the wand back into the power nozzle. The wand will then “click” into place.

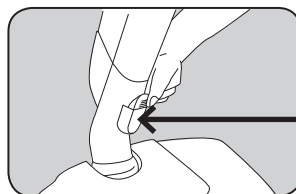

Fig. 3

How to Replace the Power Nozzle Belt

FB-HMP Model

The brushroll may need to be removed at times, to cut threads that have become tangled around it or to replace the belt.

1. Turn the nozzle over and squeeze the tabs in the middle toward each other. Then lift up on the tabs on the outer edges. Lift off the baseplate (Fig. 1).
2. Lift the non-belt end of the brushroll out of the nozzle first. Remove the belt from the brushroll and motor pulley (Fig. 2).
3. To install a new belt, loop the belt around the motor pulley and then around the brushroll (Fig. 3).
4. Insert the belt end of the brushroll into the nozzle. Then push the other end of the brushroll into the nozzle. Turn the brushroll with your hand to ensure it is installed correctly.
5. To replace the baseplate, insert the tabs on the front of the baseplate into the grooves of the nozzle. Push the baseplate onto the nozzle making sure all four tabs lock into place.

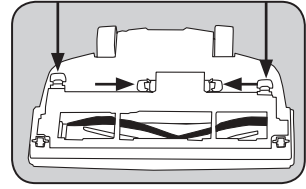

Fig. 1

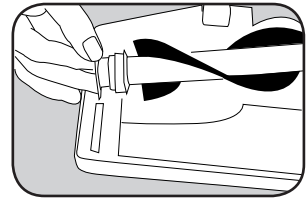

Fig. 2

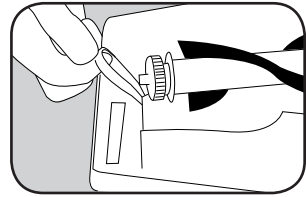

Fig. 3

Troubleshooting Guide

Please check each item below if you have trouble with your vacuum.

Unplug the vacuum from the power supply before servicing.

Problem	Check Point	Possible Solution
Suction power is weak.	<ul style="list-style-type: none">• Vacuum bag• Wand or hose	<ul style="list-style-type: none">• If vacuum bag is full, replace it.• If clogged or blocked, remove the object.
The vacuum does not work.	<ul style="list-style-type: none">• Is the hose adapter inserted into the suction opening of the vacuum completely?• When the vacuum bag is full or any of the accessories are blocked, the over-heating protection for the motor is activated.	<ul style="list-style-type: none">• Insert hose until it snaps into place.• Turn the vacuum off and unplug the vacuum. Check the vacuum bag and accessories and remove any blockages. The vacuum can be turned on again after approximately 20 minutes.
Power cord does not rewind.	<ul style="list-style-type: none">• Power cord	<ul style="list-style-type: none">• Pull the power cord out a little and press the cord rewind button again.
Power cord won't pull out of the vacuum.	<ul style="list-style-type: none">• Power cord	<ul style="list-style-type: none">• Do not pull it out by force. Rewind it a little by pressing the cord rewind button and try pulling it out again.

For Best Performance

- Keep machine and all accessories clean and in good operating condition.
- Replace filters after using 6 to 12 vacuum bags or more frequently if vacuuming fine powders such as flour or dry wall dust.
- Always use genuine filters and parts, as use of other products may result in poor cleaning or filtration performance. Fuller Brush filtration products are designed for maximum performance.
- Store machine carefully in a dry area.
- For optimum cleaning performance and safety, follow your owner's manual.

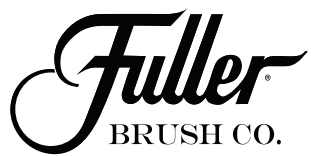

Fuller Brush Vacuum Cleaners
PO Box 730
Fenton, MO 63026

www.FullerBrushVacuums.com